





-  Meets IEEE 802.3 Standards.
-  Designed For 1G,2.5G/5.0G BASE-T Applications, Surface Mount Type.
-  Operating Temperature Range: -40°C to +85°C.
-  RoHS Compliant.

Part Number	Electrical Specifications @25°C						
	Turns Ratio (±5%)	OCL(μH Min) @100KHz,0.1V With 8mA DC Bias	CWW(pF Max) @100KHz,0.1V	DCR (Ω Max)	Insertion Loss (dB Max)	Return Loss (dB Min)	HI-POT (Vrms)
FB020G00	1CT:1CT	120	35	3.0	-0.5@1-50MHz -1.0@50-125MHz -2.0@125-250MHz	-18@1-40MHz -18+10*Log(F/40)@40-250MHz	1500

MECHANICAL

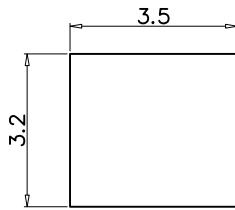

TOP VIEW

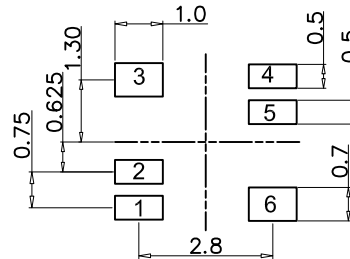

SUGGEST LAYOUT

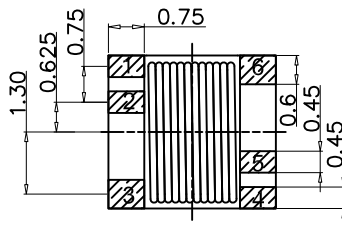

BOTTOM VIEW

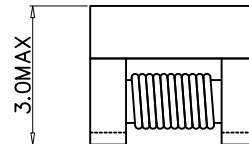

FRONT VIEW

Unless otherwise specified all tolerances are:±0.25 in mm

SCHEMATICS

